

Spartan Doors - Industrial Door



Product Data Sheet

Spartan Doors manufactures specialised doors and frames for commercial and industrial applications.

Industrial Door

Public access metal clad door with polystyrene solid core.

Description

The Industrial Door is a multi-purpose lightweight metal clad door. It has the same advantages of a solid timber door, with the added benefit of durability in extreme climate conditions.

The Industrial Door is comprised of a rigid polystyrene core with enveloped and cleated steel sheets - adding to the overall security and weather resistance of the door. Both side edges feature full length timber stiles to provide strong fixing points for the hinges and lock mechanism. Standard door hardware can be fitted on request as well as specialised options such as vision panels and ventilation grills.

Application

Warehouses, sheds, perimeter fences, schools, transportable buildings, garages, internal doors.

Finishes

0.55mm Colorbond Steel is the standard finish. Zinalume, galvanised steel, aluminium and stainless steel are also available. Thicknesses up to 1.5mm can be supplied for additional security and durability.



All statements, technical information, and recommendations related to Spartan's products are based on information believed to be reliable, but the accuracy or completeness is not guaranteed. Before using this product, you must evaluate it and determine if it is suitable for your intended application.



110 Mitchell Ave, Kurri Kurri, NSW, 2327, AUSTRALIA
PHONE: 1300 784 852 | FAX: 1300 784 952
EMAIL: info@spartandoors.com.au
WEB: www.spartandoors.com.au.com.au

© 2018

Spartan Doors - Industrial Door

Specification

Based on standard door configuration. Other size, core, finish, frame and hardware options are available.

Size: Single - 2040mm high x 870mm wide x 35mm thick
Double - 2040mm high x 820/820mm wide x 35mm thick

Design: Cleat finish to lock edge with pan fold to other three edges retained by adhesive and rivets.

Finish: Colorbond sheet 0.55mm.

Core: Rigid polystyrene with internal timber stiles.

Frame: 1.5mm BMT push in pressed metal profile 4 sides.

Lock: Centrally pre-drilled door leaf for cylindrical lock set at 70mm backset.

Hinges: 3 x stainless steel 100mm x 75mm x 1.5mm hinges welded in the frame.

Weight: Leaf - 25KG
Frame - 10KG

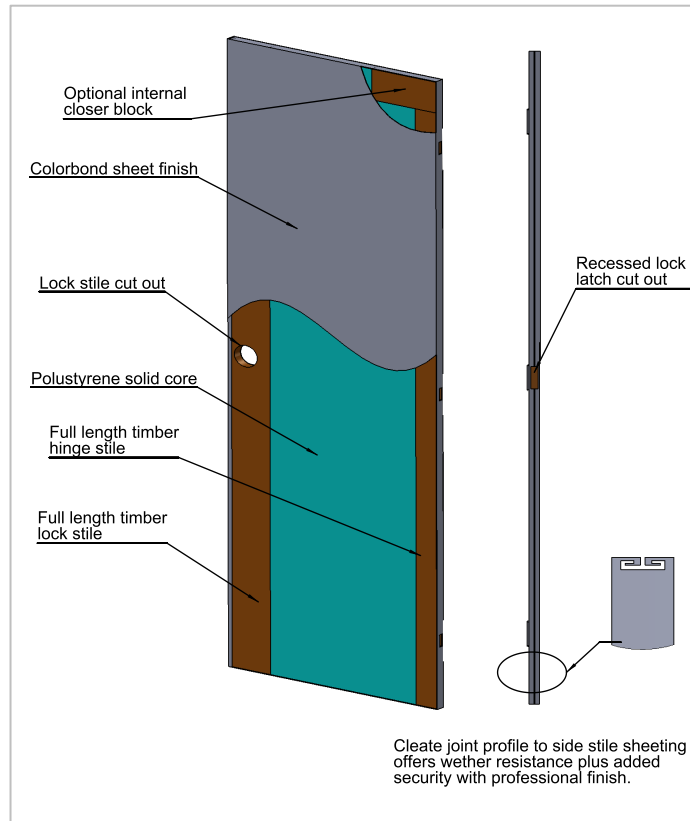

To Specify

Door shall be Spartan Industrial 35mm thick door leaf comprising a solid polystyrene core with internal timber stiles covered with 0.55mm Colorbond. Cleat finish on seam to lock edge. Prehung in a Spartan 1.5mm BMT push in pressed 4 sided metal frame. Other hardware can be fitted by Spartan Doors as specified.

To Order

Refer to the Industrial Door order sheet for a full list of options and ordering information.

For further information please contact Spartan Doors or your nearest Spartan Doors dealer.