

OTHERS FOR FIRECORE MINI & MAXI FIRE DOORSET LIFE SAFETY DOOR

- **Firecore Fire door with Kilargo HP2512BW or IS1212 or IS7025Si Perimeter Seal**

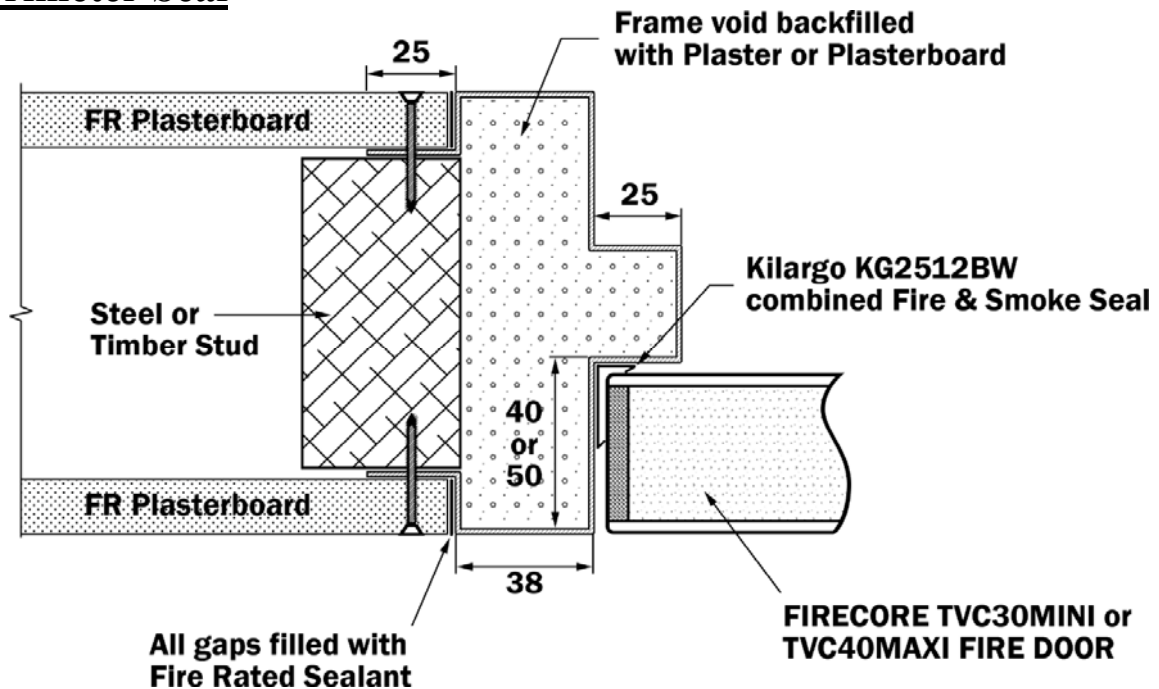

- **Firecore Fire door with Kilargo IS8010Si Threshold Seal**

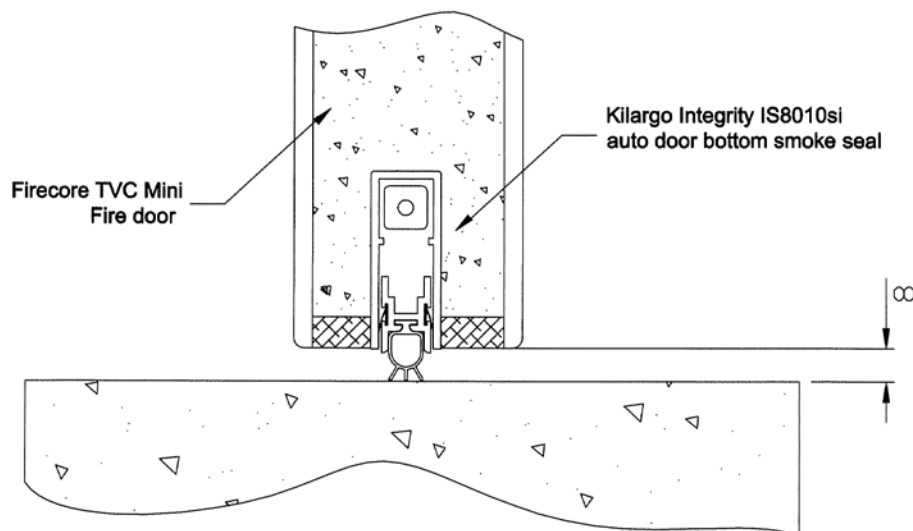

NOTE

1. Door finished thickness nominal Mini door leaf 37mm and Maxi door leaf 47mm
2. Steel Frame Rebate Size: Mini 40mm x 25mm and Maxi 50mm x 25mm
3. Minimum hinge requirements: 3 Hinges
4. Steel frame to be backfilled with concrete or mortar into Masonry wall, plasterboard strips & plaster into Plasterboard wall
5. Complies with AS1905.1 & tested in accordance with AS 1530.4-2005 & AS1530.7-2007

OTHERS FOR FIRECORE MINI & MAXI FIRE DOORSET LIFE SAFETY DOOR (Cont'd)

- **AVAILABLE**
- **Kilargo KG2512BW Perimeter Seal with Kilargo IS8010Si Threshold Seal**

| Maximum Door Leaf Size (H x W) (mm) | Smoke Leakage (m ³ /hr.) at 25pa & Ambient temperature | Smoke Leakage (m ³ /hr.) at 25pa & Medium temperature (200°C) for at least 30 minutes | Fire Resistance Level (FRL) | Rw NATA-RMIT - 1211/05 | Reference |
|-------------------------------------|---|--|-----------------------------|------------------------|-----------------------------|
| Mini Single 2400 x 1200 | 2 | 5 | -/120/30 | 31 | EWFA 2693000 26966-01 |
| Maxi Single 2400 x 1200 | 2 | 5 | -/240/30 | 33 | EWFA 2693000 26966-01 |
| Maxi Double 2400 x 2400 | 4 | 2 | -/240/30 | 34 | EWFA 2693001 26966-01 |

- **AVAILABLE**
- **Kilargo IS1212 Perimeter Seal with Kilargo IS8010Si Threshold Seal**

| Maximum Door Leaf Size (H x W) (mm) | Smoke Leakage (m ³ /hr.) at 25pa & Ambient temperature | Smoke Leakage (m ³ /hr.) at 25pa & Medium temperature (200°C) for at least 30 minutes | Fire Resistance Level (FRL) | Rw NATA-RMIT - 1211/05 | Reference |
|-------------------------------------|---|--|-----------------------------|------------------------|-----------------|
| Maxi Single 2400 x 1200 | 3 | 25 | -/240/30 | 33 | EWFA 2806601 |

- **AVAILABLE**
- **Kilargo IS7025Si Perimeter Seal with Kilargo IS8010Si Threshold Seal**

| Maximum Door Leaf Size (H x W) (mm) | Smoke Leakage (m ³ /hr.) at 25pa & Ambient temperature | Smoke Leakage (m ³ /hr.) at 25pa & Medium temperature (200°C) for at least 30 minutes | Fire Resistance Level (FRL) | Rw NATA-RMIT - 1211/05 | Reference |
|-------------------------------------|---|--|-----------------------------|------------------------|-----------------|
| Mini Single 2400 x 1200 | <2 | 65 & Note D | -/120/30 | 31 | EWFA 2806600 |